

INSTALLATION INSTRUCTIONS



Water Connects Us®



SC-2763
Square Wall-hung
Closet

BEFORE YOU BEGIN



WARNING: Risk of personal injury or product damage. Handle with care.

▪ **FOR BEST PERFORMANCE OF YOUR SLOAN® WATER CLOSET, USE SLOAN® TRUFLUSH FLUSHOMETERS**

- Vitreous China can break or chip if the bolts and nuts are over-tightened, or if the product is handled carelessly.
- Observe all local plumbing and building codes.
- Carefully inspect the new toilet for any damage.
- If the In-wall tank is not installed, refer to the manufacturer's instructions before installation.

✓ Minimum Flowing Pressure: 25 PSI

✓ Minimum Flow Rate: 68 LPM

✓ Maximum Static Pressure: 70 PSI before installation.



RECOMMENDED TOOLS AND MATERIALS:-



Putty Knife



Adjustable Wrench



Level

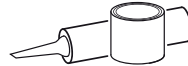

Silicone

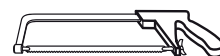

Hacksaw



Tape Measure

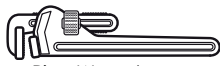

Pipe Wrench



Drill



Channel Lock Pliers



Phillips Screwdriver



Regular Screwdriver

ROUGHING-IN

Units : mm

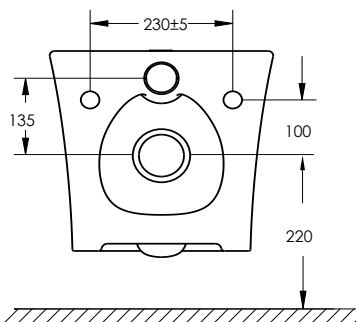
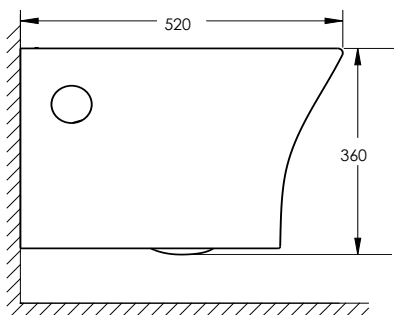
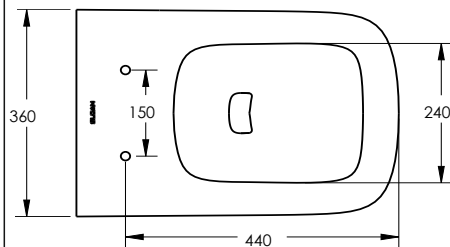

Note:- All vitreous china dimensions shown in these drawings are nominal. Dimensions can vary within the tolerances established in the governing BIS standard. Please take this into consideration when planning rough-in and plumbing layouts. Product illustrations shown are representative only; actual products may vary. Sloan reserves the right to make changes in product characteristics, packaging or availability at any time without notice.



CAUTION : Do not use white cement or high lime-content cement to install this toilet. The expansion of cement due to rise in temperature may cause the toilet to crack or damage. Sloan is not responsible for any damage due to installation with the use of cement.



SLOAN INDIA PRIVATE LIMITED

344, PHASE-II, UDYOG VIHAR, GURGAON 122015 Phone: (+91) 124-601333

Toll Free: 1800.123.3080 | customercare@sloan.in | sloan.com Copyright © 2021 Sloan. All rights reserved.

INSTALLATION GUIDELINE

1 Cut bolts if needed. File bolt ends. 	2 Remove Inlet Plug. 	3 Slide the gaskets on the Inlet & Outlet pipe as shown. 	4 Slide the inlet pipe into the wall openings
5 Note the distance between the wall & the toilet at the location shown. Measure excess length "A" on the inlet pipe. 	6 Remove the toilet. Cut & file the inlet pipe to proper length by removing excess length "A". 	7 Slide the outlet pipe into the wall openings at waste outlet to test the fitment of outlet pipe with toilet. 	8 Note the distance between the wall & the toilet at the location shown. Measure excess length "B" of the outlet pipe.
9 Remove the toilet. Cut & file the outlet pipe to proper length by removing excess length "B". 	10 Add silicon sealant in the gasket grooves. 	11 Mount the toilet on the projected studs. 	12 Fix the toilet
13 Level the toilet with Spirit level. 	14 Flush the toilet. Check for leaks. Seal connections if required. 	15 Complete the Installation 	16 Finish the Installation. Seal around the edges. do not use cement

Note: Dimension A & B (as represented in pictures 5 to 9 above) to be adjusted as per specific site requirements.
 -Product illustrations shown are representative only; actual products may vary.

SERVICE /SPARE PART :-

1. SC-23-A
 (MMN-02012018)
 Slim - Square Seat Cover



LIMITED WARRANTY

Sloan Valve Company warrants its vitreous china products to be made of first class materials, free from defects of material or workmanship under normal use and to perform the service for which they are intended in a thoroughly reliable and efficient manner when properly installed and serviced, for a period of five years from date of purchase. During this period, Sloan Valve Company will, at its option, repair or replace any part or parts which prove to be thus defective if returned to Sloan Valve Company, at customer's cost, and this shall be the sole remedy available under this warranty. No claims will be allowed for labor, transportation or other incidental costs. This warranty extends only to persons or organizations who purchase Sloan Valve Company's products directly from Sloan Valve Company for purpose of resale.

THERE ARE NO WARRANTIES WHICH EXTEND BEYOND THE DESCRIPTION ON THE FACE HERE OF. IN NO EVENT IS SLOAN VALVE COMPANY RESPONSIBLE FOR ANY CONSEQUENTIAL DAMAGES OF ANY MEASURE WHATSOEVER. NOTE: IN NO EVENT SHALL THE SLOAN VALVE COMPANY BE LIABLE FOR INCIDENTAL DAMAGES, RESULTING FROM IMPROPER INSTALLATION, OR FOR DAMAGES CAUSED BY NEGLIGENCE, ABUSE OR ALTERATION.

SLOAN

SLOAN INDIA PRIVATE LIMITED

344, PHASE-II, UDYOG VIHAR, GURGAON 122015 Phone: (+91) 124-601333

Toll Free: 1800.123.3080 | customercare@sloan.in | sloan.com Copyright © 2021 Sloan. All rights reserved.